

CERAMIC STRIP HEATERS

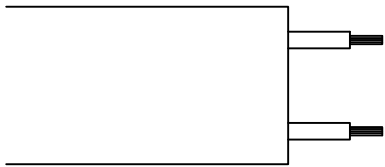

TYPE R

PLAIN LEADS. DESIGNED FOR MAX. HEATED LENGTH AND TO ACCOMMODATE APPLICATIONS WHERE LEADS CAN ONLY BE ACCESSED FROM ONE END & HEIGHT CLEARANCE IS A CONCERN.
300mm (12") STD (SS BRAID OPTIONAL). TAB OPTION AVAILABLE ONLY ON END OPPOSITE TO LEAD-EXIT END

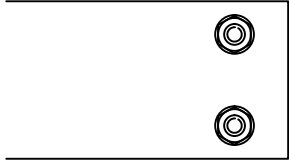

TYPE L

THREADED POST TERMINALS, IDEAL FOR APPLICATIONS WHERE LEAD ACCESS MUST BE FROM ONE SIDE.
STD HEATED LENGTH= OVERALL LENGTH-50mm (2")

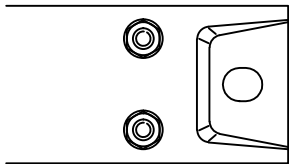
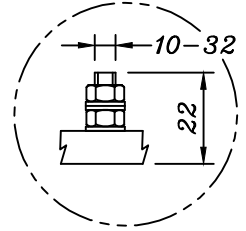

TYPE L + TABS

THREADED POST TERMINALS, IDEAL FOR APPLICATIONS WHERE LEAD ACCESS MUST BE FROM ONE SIDE.
SECURING TAB EACH END
STD HEATED LENGTH= OVERALL LENGTH-100mm (4")

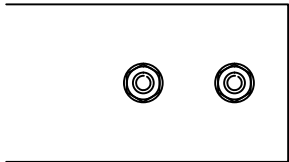

TYPE J

THREADED POST TERMINALS, IDEAL FOR APPLICATIONS WHERE LEAD ACCESS MUST BE FROM ONE SIDE.
STD HEATED LENGTH= OVERALL LENGTH-75mm (3")

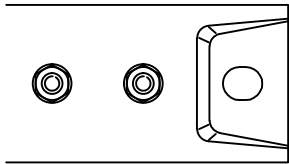
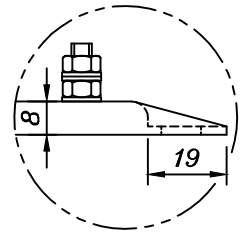

TYPE J + TABS

THREADED POST TERMINALS, IDEAL FOR APPLICATIONS WHERE LEAD ACCESS MUST BE FROM ONE SIDE.
STD HEATED LENGTH= OVERALL LENGTH-125mm (5")

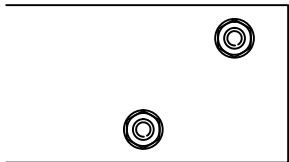

TYPE M

THREADED POST TERMINALS, IDEAL FOR APPLICATIONS WHERE LEAD ACCESS MUST BE FROM ONE SIDE.
STD HEATED LENGTH= OVERALL LENGTH-75mm (3")

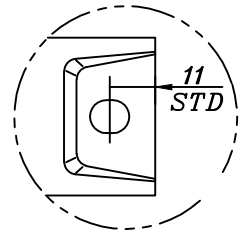

SLOT DIM's:
9.5 X 8
(3/8" X 5/16")

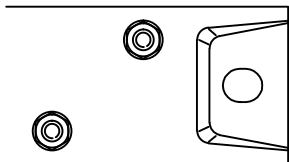

TYPE M + TABS

THREADED POST TERMINALS, IDEAL FOR APPLICATIONS WHERE LEAD ACCESS MUST BE FROM ONE SIDE.
STD HEATED LENGTH= OVERALL LENGTH-125mm (5")

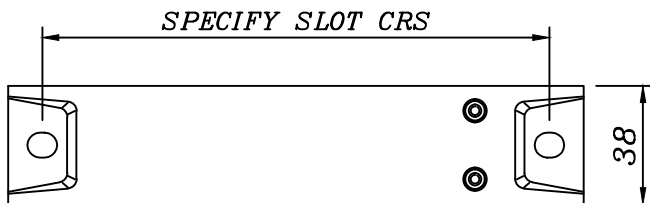

STD TYPE

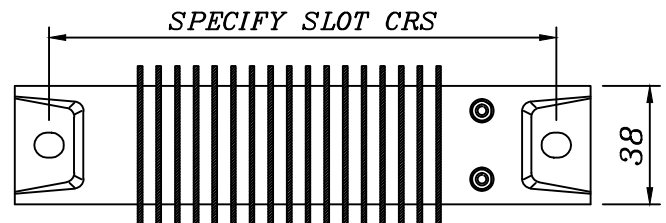

'FINNED' TYPE (PITCH: 8mm)

GENERAL SPEC's: 120 & 240V STD (OTHER VOLTAGES AVAILABLE)

WATTAGE: +5% -10%

LEADS: 250°C, 300V OR 600V FIBREGLASS

TERMINALS: 10-32 (5mm OD APP.) STAINLESS STEEL (20A RATING)